

St. Joseph's School, Stanthorpe

St. Joseph's School
100 High St, Stanthorpe QLD 4380

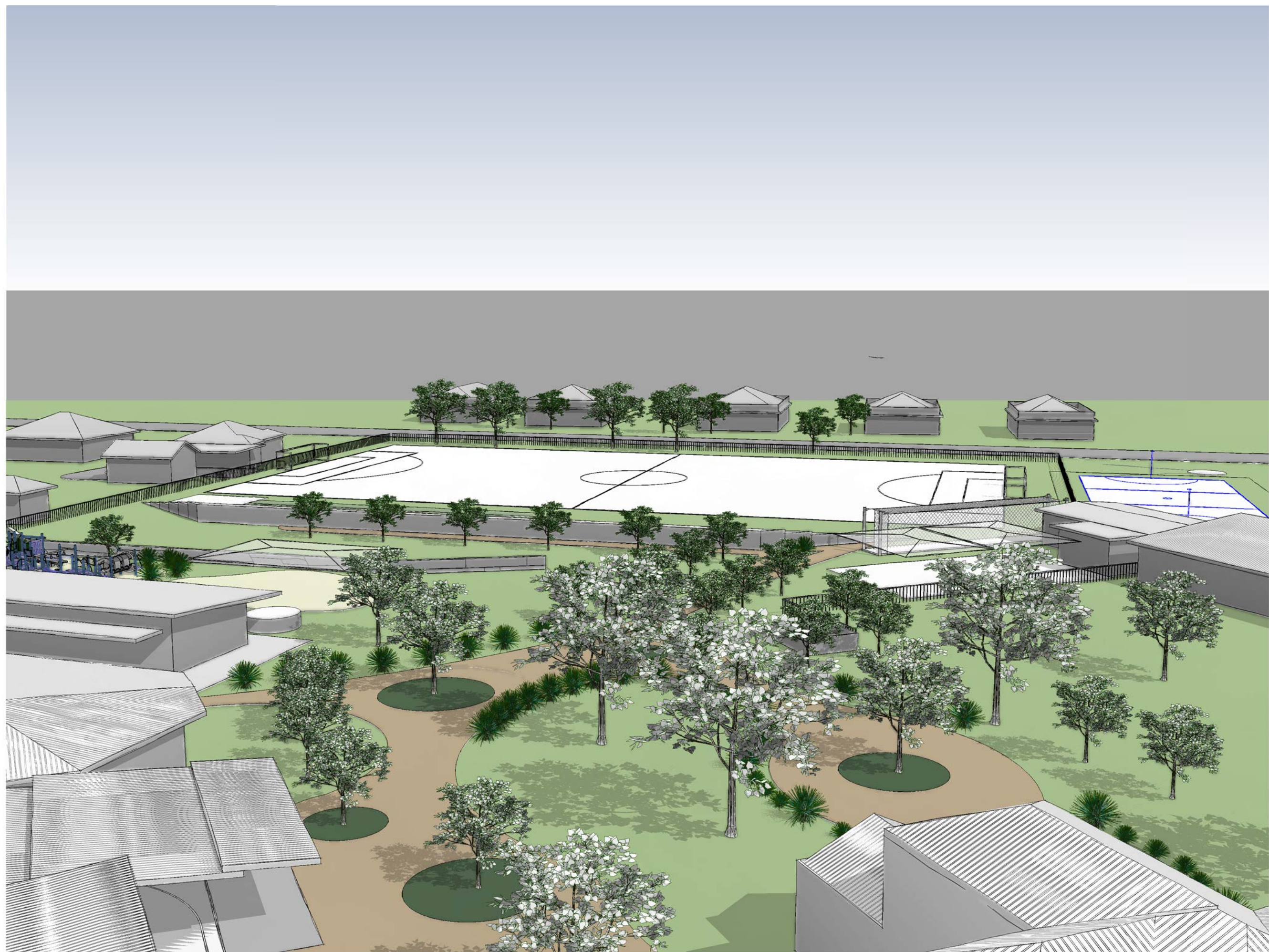

Drawing List			
Sheet Number	Sheet Name	Rev	Rev Date
A0	Title Sheet	C	06/11/18
A.00	Existing Master Plan	C	06/11/18
A.000	Proposed Master Plan	C	06/11/18
A.010	Stage 1 Master Plan	C	06/11/18
A.011	Stage 2 Master Plan	C	06/11/18
A.012	Stage 3 Master Plan	C	06/11/18
A.013	Stage 4 Master Plan	C	06/11/18
A.014	Stage 5 Master Plan	C	06/11/18
A.900	Perspectives	B	06/11/18
A.901	Perspectives	B	06/11/18



ASPECT

ARCHITECTURE
INTERIORS
PROJECT MANAGEMENT
QUANTITY SURVEYING

TOOWOOMBA BRISBANE
P. (07) 46 329 962 WWW.ASPECTAPM.NET
A.B.N 96071786948 BOAQ 4487

CONCEPT DESIGN ISSUE

Project Number

18-0802

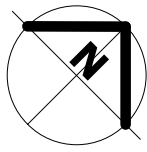

DRAWING LEGEND

- EXISTING STRUCTURES
- DEMOLISHED STRUCTURES
- PROPOSED BUILDING/ROOF STRUCTURE
- RE-FURBISHED STRUCTURES
- NEW PATHWAYS
- EXISTING CONCRETE PATHWAY
- BITUMEN ROAD
- PROPOSED GARDEN
- TURFED AREAS - EXISTING + PROPOSED
- EXISTING TREE
- NEW TREE
- DEMOLISHED TREE
- NEW SHRUBS/PLANTS

PROPERTY DESCRIPTION

- Lot 402 / S. 1682
- Lot 307 / S. 1682
- Lot 3 / S.P. 238283
- Lot 304 / S.P. 238284

County of Bentinck

STAGING LEGEND

- STAGE 1:**
- PRIMARY SCHOOL:**
- ACQUIRE LOT 1 (RP52907) - EXISTING ARCHBISHOPS HOUSE;
 - REFURBISH EXISTING ARCHBISHOPS HOUSE TO PROVIDE NEW MUSIC, DIGITAL TECH, STEM, TEXTBOOK STORAGE AND BOOK HIRE;
 - DEMOLISH EXISTING GRAVEL ROAD;
 - DEMOLISH EXISTING CRICKET NETS;
 - CONSTRUCT NEW CRICKET NETS;
 - CONSTRUCT NEW PATHING AND LANDSCAPING TO LINK INTO REFURBISHED HERITAGE BUILDING - NEW PATHING TO CONNECT INTO EXISTING AMENITIES;

- SENIOR SCHOOL:**
- CONSTRUCT NEW ROOF STRUCTURE AND PATHING TO FRAYNE BUILDING;
 - DEMOLISH EXISTING DILAPIDATED AMENITIES ADJOINING BATHERSBY HALL;
 - REFURBISH EXISTING AND PROVIDE NEW AMENITIES TO BATHERSBY HALL;
 - CONSTRUCT NEW PATHING AND LANDSCAPING INTO EXISTING ENTRY POINTS TO BATHERSBY HALL;
 - CONSTRUCT NEW ENTRY STRUCTURE TO THE SOUTHERN ENTRY OF BATHERSBY HALL;
 - CONSTRUCT NEW ENTRY STATEMENT INTO SENIOR SCHOOL VIA CORUNDUM STREET;
 - SAFETY UPGRADES TO EXISTING ITD SPACES
 - DOOR INSTALLATION AND RESOURCE CENTRE INSTALLATION TO LANGUAGE LAB
 - ACQUIRE LOT 1 (RP88794);
 - ACQUIRE LOT 2 (RP907833);
 - REFURBISH EXISTING SHED INTO AGRICULTURAL SHED TO LOT 2 (RP907833) + UPGRADE LOT 1 / RP88794 FOR AGRICULTURAL STUDIES
 - CONSTRUCT NEW LINE-MARKING TO EXISTING HARDSTAND TO LOT 2 (RP907833) TO CREATE NEW STAFF PARKING;

- STAGE 2:**
- PRIMARY SCHOOL:**
- REFURBISH EXISTING PRIMARY GLA BUILDINGS AND AMENITIES;
 - CONSTRUCT NEW COVERED ROOF OVER EXISTING BASKETBALL HALF-COURT;
 - CONSTRUCT ADDITIONAL AWNING OVER LIBRARY / ADMIN BUILDING ENTRY;
 - NEW MURAL ARTWORK TO END OF GLA BUILDING
 - RECONFIGURE OLD MUSIC AND COUNSELLOR ROOMS FOR NEW TEACHING SPACES
 - RECONFIGURE TUCKSHOP JOINERY FOR FRIDGE AND HANDWASH BASIN

- SENIOR SCHOOL:**
- REFURBISH PORTION OF PARISH CENTRE INTO NEW HISTORY ROOM;
 - DEMOLISH PORTION OF EXISTING ITD TO ALLOW FOR NEW WORKS;
 - CONSTRUCT NEW TWO-STOREY GLA AND ITD EXTENSION TO LINK INTO EXISTING HOME EC. BUILDING;
 - NEW THROW ZONE, PATHING AND LANDSCAPING
 - REFURBISH EXISTING AMENITIES

- STAGE 3:**
- PRIMARY SCHOOL:**
- ACQUIRE LOT 2 (RP62401);
 - DEMOLISH STRUCTURES AND LANDSCAPING TO LOT 2 (RP62401);
 - CONSTRUCT NEW TERRACED SEATING TO NEW SPORTING FIELD;
 - CONSTRUCT NEW JUMPS PIT AND SHOT-PUT ARENA;
 - CONSTRUCT NEW FULL-SIZE NETBALL COURT;
 - CONSTRUCT NEW PATHING TO LINK THE TERRACE WITH THE EXISTING SCHOOL PATHING NETWORK;
 - DEMOLISH EXISTING LANDSCAPING ADJOINING PREP PLAY SPACE;
 - CONSTRUCT NEW 'NINJA WARRIOR' INSPIRED PLAY SPACE;
 - CONSTRUCT NEW RETAINING WALL TO TIERED OVALS;

- SENIOR SCHOOL:**
- DEMOLISH EXISTING DILAPIDATED HARDSTAND TO CENTRAL PLAZA SPACE;
 - REFURBISH EXISTING HOME EC BUILDING;
 - CONSTRUCT NEW TUCKSHOP TO SOUTH-EASTERN SIDE OF HOME EC. BUILDING;
 - CONSTRUCT NEW ROOFED STRUCTURE BETWEEN STAFF ROOM AND HOME ECONOMICS BUILDING;

- STAGE 4:**
- PRIMARY SCHOOL:**
- ADMINISTRATION EXPANSION AND SHOWER & HANDBASIN TO BE RETROFITTED

- SENIOR SCHOOL:**
- CONSTRUCT NEW ROOF STRUCTURE AND PATHING ADJOINING SCIENCE LABS;
 - ACQUIRE LOT 1 (RP85753);
 - DEMOLISH STRUCTURES AND LANDSCAPING TO NEWLY ACQUIRED LOTS;
 - ACQUIRE LOTS 311 + 312 (RP1682);
 - DEMOLISH STRUCTURES AND LANDSCAPING TO NEWLY ACQUIRED LOTS;
 - CONSTRUCT NEW CRICKET NETS;

- STAGE 5:**
- PRIMARY SCHOOL:**
- CONSTRUCT NEW TRAFFIC ISLANDS AND DROP OFF ZONES

- SENIOR SCHOOL:**
- CONSTRUCT NEW TRAFFIC ISLANDS AND DROP OFF ZONES

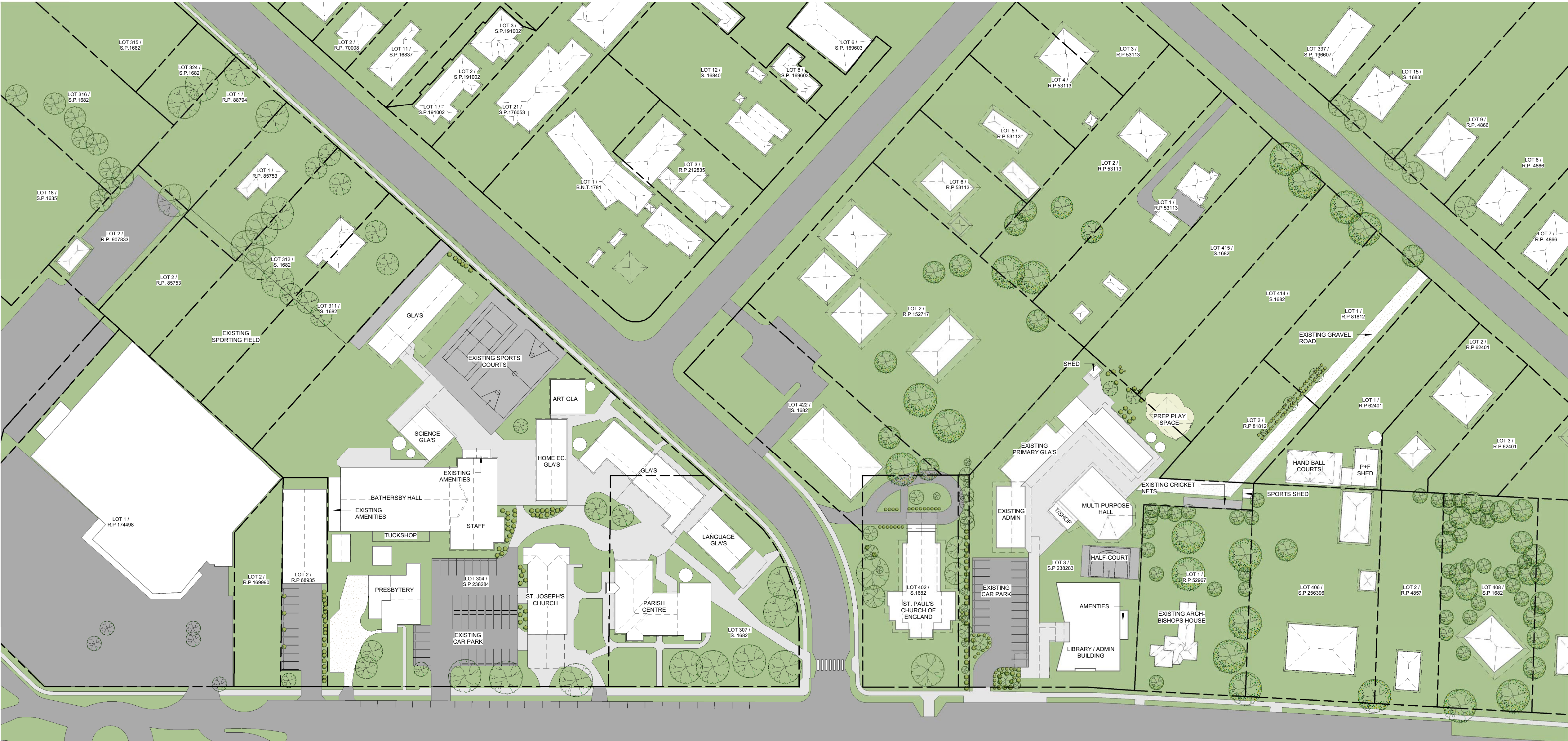

1 Existing Master Plan
1 : 750

EXISTING STRUCTURES

DEMOLISHED STRUCTURES

PROPOSED BUILDING/ROOF STRUCTURE

RE-FURNISHED STRUCTURES

NEW PATHWAYS

EXISTING CONCRETE PATHWAY

BITUMEN ROAD

PROPOSED GARDEN

TURFED AREAS - EXISTING + PROPOSED

EXISTING TREE

NEW TREE

DEMOLISHED TREE

NEW SHRUBS/PLANTS

PROPERTY DESCRIPTION

Lot 402 / S. 1682

Lot 307 / S. 1682

Lot 3 / S.P. 238283

Lot 304 / S.P. 238284

County of Bentinck

- STAGING LEGEND**

STAGE 1:

PRIMARY SCHOOL:
 - ACQUIRE LOT 1 (RP52967) - EXISTING ARCHBISHOPS HOUSE; REFURBISH EXISTING ARCHBISHOPS HOUSE TO PROVIDE NEW MUSIC, DIGITAL TECH, STEM, TEXTBOOK STORAGE AND BOOK HIRE;
 - DEMOLISH EXISTING GRAVEL ROAD;
 - DEMOLISH EXISTING CRICKET NETS;
 - CONSTRUCT NEW CRICKET NETS;
 - CONSTRUCT NEW PATHING AND LANDSCAPING TO LINK INTO REFURBISHED HERITAGE BUILDING - NEW PATHING TO CONNECT INTO EXISTING AMENITIES.

SENIOR SCHOOL:
 - CONSTRUCT NEW ROOF STRUCTURE AND PATHING TO FRAYNE BUILDING;
 - DEMOLISH EXISTING DILAPIDATED AMENITIES ADJOINING BATHERSBY HALL;
 - REFURBISH EXISTING AND PROVIDE NEW AMENITIES TO BATHERSBY HALL;
 - CONSTRUCT NEW PATHING AND LANDSCAPING INTO EXISTING ENTRY POINTS TO BATHERSBY HALL;
 - CONSTRUCT NEW ENTRY STRUCTURE TO THE SOUTHERN ENTRY OF BATHERSBY HALL;
 - CONSTRUCT NEW ENTRY STATEMENT INTO SENIOR SCHOOL VIA CORUNDUM STREET;
 - SAFETY UPGRADES TO EXISTING ITD SPACES
 - DOOR INSTALLATION AND RESOURCE CENTRE INSTALLATION TO LANGUAGE LAB
 - ACQUIRE LOT 1 (RP88794);
 - ACQUIRE LOT 2 (RP907833);
 - REFURBISH EXISTING SHED INTO AGRICULTURAL SHED TO LOT 2 (RP907833) + UPGRADE LOT 1 / RP88794 FOR AGRICULTURAL STUDIES
 - CONSTRUCT NEW LINE-MARKING TO EXISTING HARDSTAND TO LOT 2 (RP907833) TO CREATE NEW STAFF PARKING;

STAGE 2:

PRIMARY SCHOOL:
 - REFURBISH EXISTING PRIMARY GLA BUILDINGS AND AMENITIES;
 - CONSTRUCT NEW COVERED ROOF OVER EXISTING BASKETBALL HALF-COURT;
 - CONSTRUCT ADDITIONAL AWNING OVER LIBRARY / ADMIN BUILDING ENTRY;
 - NEW MURAL ARTWORK TO END OF GLA BUILDING
 - RECONFIGURE OLD MUSIC AND COUNSELLOR ROOMS FOR NEW TEACHING SPACES
 - RECONFIGURE TUCKSHOP JOINERY FOR FRIDGE AND HANDWASH BASIN

SENIOR SCHOOL:
 - REFURBISH PORTION OF PARISH CENTRE INTO NEW HISTORY ROOM;
 - DEMOLISH PORTION OF EXISTING ITD TO ALLOW FOR NEW WORKS;
 - CONSTRUCT NEW TWO-STORY GLA AND ITD EXTENSION TO LINK INTO EXISTING HOME EC. BUILDING;
 - NEW THROW ZONE, PATHING AND LANDSCAPING
 - REFURBISH EXISTING AMENITIES

STAGE 3:

PRIMARY SCHOOL:
 - ACQUIRE LOT 2 (RP62401);
 - DEMOLISH STRUCTURES AND LANDSCAPING TO LOT 2 (RP62401);
 - CONSTRUCT NEW TERRACED SEATING TO NEW SPORTING FIELD;
 - CONSTRUCT NEW JUMPS PIT AND SHOT-PUT ARENA;
 - CONSTRUCT NEW FULL-SIZE NETBALL COURT;
 - CONSTRUCT NEW PATHING TO LINK THE TERRACE WITH THE EXISTING SCHOOL PATHING NETWORK;
 - DEMOLISH EXISTING LANDSCAPING ADJOINING PREP PLAY SPACE;
 - CONSTRUCT NEW 'NINJA WARRIOR' INSPIRED PLAY SPACE;
 - CONSTRUCT NEW RETAINING WALL TO TIERED OVALS;

SENIOR SCHOOL:
 - DEMOLISH EXISTING DILAPIDATED HARDSTAND TO CENTRAL PLAZA SPACE;
 - REFURBISH EXISTING HOME EC BUILDING;
 - CONSTRUCT NEW TUCKSHOP TO SOUTH-EASTERN SIDE OF HOME EC. BUILDING;
 - CONSTRUCT NEW ROOFED STRUCTURE BETWEEN STAFF ROOM AND HOME ECONOMICS BUILDING.

STAGE 4:

PRIMARY SCHOOL:
 - ADMINISTRATION EXPANSION AND SHOWER & HANDBASIN TO BE RETROFITTED

SENIOR SCHOOL:
 - CONSTRUCT NEW ROOF STRUCTURE AND PATHING ADJOINING SCIENCE LABS;
 - ACQUIRE LOT 1 (RP85753);
 - DEMOLISH STRUCTURES AND LANDSCAPING TO NEWLY ACQUIRED LOTS;
 - ACQUIRE LOTS 311 + 312 (RP1682);
 - DEMOLISH STRUCTURES AND LANDSCAPING TO NEWLY ACQUIRED LOTS;
 - CONSTRUCT NEW CRICKET NETS;

STAGE 5:

PRIMARY SCHOOL:
 - CONSTRUCT NEW TRAFFIC ISLANDS AND DROP OFF ZONES

SENIOR SCHOOL:
 - CONSTRUCT NEW TRAFFIC ISLANDS AND DROP OFF ZONES
 - CONSTRUCT NEW TIERED SPORTS SEATING;
 - CONSTRUCT NEW LONG JUMP PIT;
 - UPGRADE SPORTING FIELD
 - NEW MURAL ARTWORK TO SHOPPING CENTRE WALL

1 Proposed Master Plan
1 : 750

ASPECT

ARCHITECTURE
INTERIORS
PROJECT MANAGEMENT
QUANTITY SURVEYING

St. Joseph's School, Stanthorpe

Proposed Master Plan

A.000

Project No. 18-0802

TOOWOOMBA | BRISBANE
P. (07) 46 329 962 | WWW.ASPECTAPM.NET
A.B.N 96071786948 | BOAQ 4487

CONCEPT DESIGN ISSUE

Revision C | 06/11/18

Designer KGM

Scale As indicated @ A1

1 2 3 4

DRAWING LEGEND

- EXISTING STRUCTURES
- DEMOLISHED STRUCTURES
- PROPOSED BUILDING/ROOF STRUCTURE
- RE-FURBISHED STRUCTURES
- NEW PATHWAYS
- EXISTING CONCRETE PATHWAY
- BITUMEN ROAD
- PROPOSED GARDEN
- TURFED AREAS - EXISTING + PROPOSED
- EXISTING TREE
- NEW TREE
- DEMOLISHED TREE
- NEW SHRUBS/PLANTS

STAGING LEGEND

STAGE 1:

PRIMARY SCHOOL:

- ACQUIRE LOT 1 (RP52967) - EXISTING ARCHBISHOPS HOUSE; REFURBISH EXISTING ARCHBISHOPS HOUSE TO PROVIDE NEW MUSIC, DIGITAL TECH, STEM, TEXTBOOK STORAGE AND BOOK HIRE;
- DEMOLISH EXISTING GRAVEL ROAD;
- DEMOLISH EXISTING CRICKET NETS;
- CONSTRUCT NEW CRICKET NETS;
- CONSTRUCT NEW PATHING AND LANDSCAPING TO LINK INTO REFURBISHED HERITAGE BUILDING - NEW PATHING TO CONNECT INTO EXISTING AMENITIES.

SENIOR SCHOOL:

- CONSTRUCT NEW ROOF STRUCTURE AND PATHING TO FRAYNE BUILDING;
- DEMOLISH EXISTING DILAPIDATED AMENITIES ADJOINING BATHERSBY HALL;
- REFURBISH EXISTING AND PROVIDE NEW AMENITIES TO BATHERSBY HALL;
- CONSTRUCT NEW PATHING AND LANDSCAPING INTO EXISTING ENTRY POINTS TO BATHERSBY HALL;
- CONSTRUCT NEW ENTRY STRUCTURE TO THE SOUTHERN ENTRY OF BATHERSBY HALL;
- CONSTRUCT NEW ENTRY STATEMENT INTO SENIOR SCHOOL VIA CORUNDUM STREET;
- SAFETY UPGRADES TO EXISTING ITD SPACES
- DOOR INSTALLATION AND RESOURCE CENTRE INSTALLATION TO LANGUAGE LAB
- ACQUIRE LOT 1 (RP88794);
- ACQUIRE LOT 2 (RP907833);
- REFURBISH EXISTING SHED INTO AGRICULTURAL SHED TO LOT 2 (RP907833) + UPGRADE LOT 1 / RP88794 FOR AGRICULTURAL STUDIES
- CONSTRUCT NEW LINE-MARKING TO EXISTING HARDSTAND TO LOT 2 (RP907833) TO CREATE NEW STAFF PARKING;

STAGE 2:

PRIMARY SCHOOL:

- REFURBISH EXISTING PRIMARY GLA BUILDINGS AND AMENITIES;
- CONSTRUCT NEW COVERED ROOF OVER EXISTING BASKETBALL HALF-COURT;
- CONSTRUCT ADDITIONAL AWNING OVER LIBRARY / ADMIN BUILDING ENTRY;
- NEW MURAL ARTWORK TO END OF GLA BUILDING
- RECONFIGURE OLD MUSIC AND COUNSELLOR ROOMS FOR NEW TEACHING SPACES
- RECONFIGURE TUCKSHOP JOINERY FOR FRIDGE AND HANDWASH BASIN

SENIOR SCHOOL:

- REFURBISH PORTION OF PARISH CENTRE INTO NEW HISTORY ROOM;
- DEMOLISH PORTION OF EXISTING ITD TO ALLOW FOR NEW WORKS;
- CONSTRUCT NEW TWO-STORY GLA AND ITD EXTENSION TO LINK INTO EXISTING HOME EC BUILDING;
- NEW THROW ZONE: PATHING AND LANDSCAPING
- REFURBISH EXISTING AMENITIES

STAGE 3:

PRIMARY SCHOOL:

- ACQUIRE LOT 2 (RP62401);
- DEMOLISH STRUCTURES AND LANDSCAPING TO LOT 2 (RP62401);
- CONSTRUCT NEW TERRACED SEATING TO NEW SPORTING FIELD;
- CONSTRUCT NEW JUMPS PIT AND SHOT-PUT ARENA;
- CONSTRUCT NEW FULL-SIZE NETBALL COURT;
- CONSTRUCT NEW PATHING TO LINK THE TERRACE WITH THE EXISTING SCHOOL PATHING NETWORK;
- DEMOLISH EXISTING LANDSCAPING ADJOINING PREP PLAY SPACE;
- CONSTRUCT NEW 'NINJA WARRIOR' INSPIRED PLAY SPACE;
- CONSTRUCT NEW RETAINING WALL TO TIERED OVALS;

SENIOR SCHOOL:

- DEMOLISH EXISTING DILAPIDATED HARDSTAND TO CENTRAL PLAZA SPACE;
- REFURBISH EXISTING HOME EC BUILDING;
- CONSTRUCT NEW TUCKSHOP TO SOUTH-EASTERN SIDE OF HOME EC BUILDING;
- CONSTRUCT NEW ROOFED STRUCTURE BETWEEN STAFF ROOM AND HOME ECONOMICS BUILDING.

STAGE 4:

PRIMARY SCHOOL:

- ADMINISTRATION EXPANSION AND SHOWER & HANDBASIN TO BE RETROFITTED

SENIOR SCHOOL:

- CONSTRUCT NEW ROOF STRUCTURE AND PATHING ADJOINING SCIENCE LABS;
- ACQUIRE LOT 1 (RP85753);
- DEMOLISH STRUCTURES AND LANDSCAPING TO NEWLY ACQUIRED LOTS;
- ACQUIRE LOTS 311 + 312 (RP1682);
- DEMOLISH STRUCTURES AND LANDSCAPING TO NEWLY ACQUIRED LOTS;
- CONSTRUCT NEW CRICKET NETS;

STAGE 5:

PRIMARY SCHOOL:

- CONSTRUCT NEW TRAFFIC ISLANDS AND DROP OFF ZONES

SENIOR SCHOOL:

- CONSTRUCT NEW TRAFFIC ISLANDS AND DROP OFF ZONES
- CONSTRUCT NEW TIERED SPORTS SEATING;
- CONSTRUCT NEW LONG JUMP PIT;
- UPGRADE SPORTING FIELD

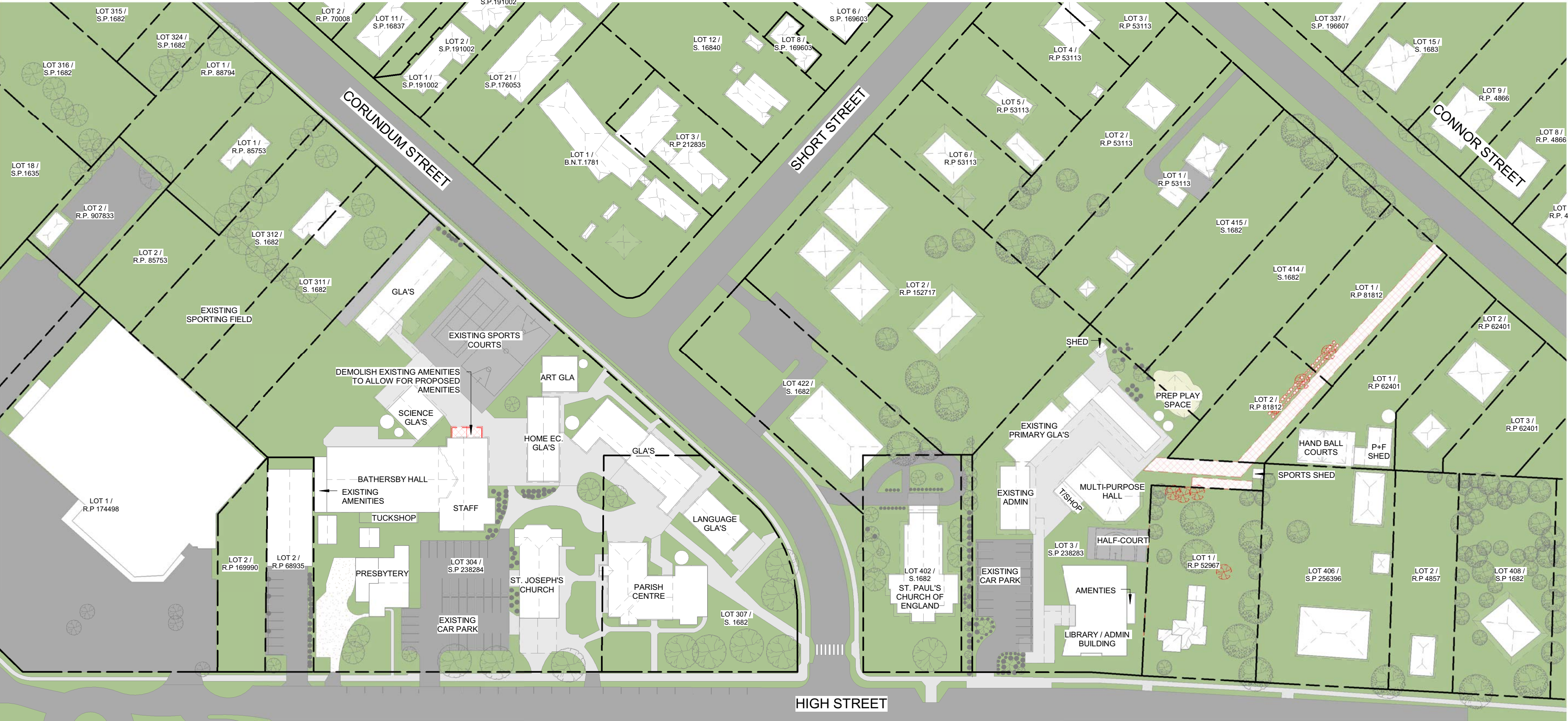

2 Stage 1 Demolition
1:1000

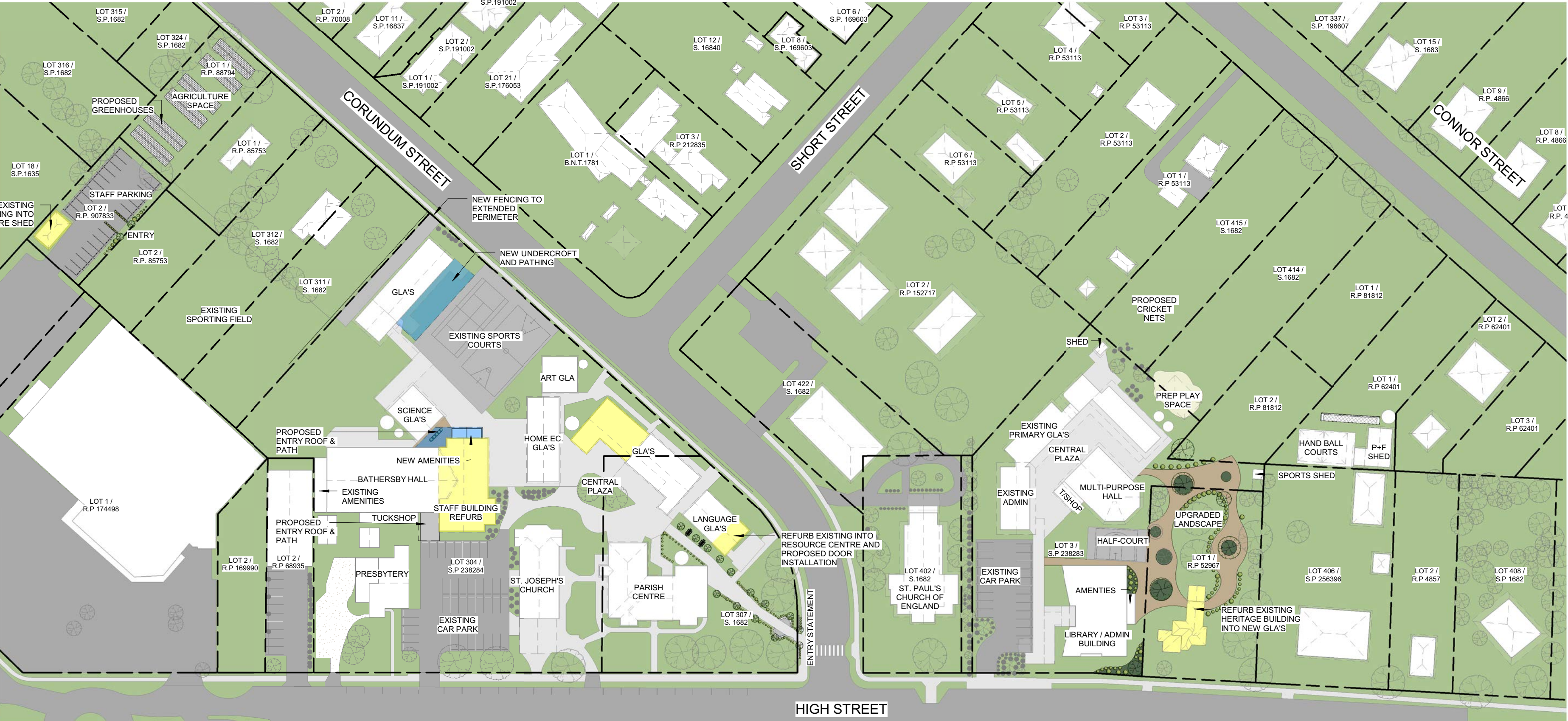

1 Stage 1 Proposed
1:1000

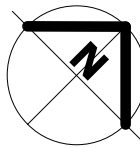

EXISTING STRUCTURES

DEMOLISHED STRUCTURES

PROPOSED BUILDING/ROOF STRUCTURE

RE-FURNISHED STRUCTURES

NEW PATHWAYS

EXISTING CONCRETE PATHWAY

BITUMEN ROAD

PROPOSED GARDEN

TURFED AREAS - EXISTING + PROPOSED

EXISTING TREE

NEW TREE

DEMOLISHED TREE

NEW SHRUBS/PLANTS

STAGING LEGEND

STAGE 1:

PRIMARY SCHOOL:

ACQUIRE LOT 1 (RP52967) - EXISTING ARCHBISHOPS HOUSE;

REFURBISH EXISTING ARCHBISHOPS HOUSE TO PROVIDE NEW MUSIC, DIGITAL TECH, STEM, TEXTBOOK STORAGE AND BOOK HIRE;

DEMOLISH EXISTING GRAVEL ROAD;

DEMOLISH EXISTING CRICKET NETS;

CONSTRUCT NEW CRICKET NETS;

CONSTRUCT NEW PATHING AND LANDSCAPING TO LINK INTO REFURBISHED HERITAGE BUILDING - NEW PATHING TO CONNECT INTO EXISTING AMENITIES.

SENIOR SCHOOL:

CONSTRUCT NEW ROOF STRUCTURE AND PATHING TO FRAYNE BUILDING;

DEMOLISH EXISTING DILAPIDATED AMENITIES ADJOINING BATHERSBY HALL;

REFURBISH EXISTING AND PROVIDE NEW AMENITIES TO BATHERSBY HALL;

CONSTRUCT NEW PATHING AND LANDSCAPING INTO EXISTING ENTRY POINTS TO BATHERSBY HALL;

CONSTRUCT NEW ENTRY STRUCTURE TO THE SOUTHERN ENTRY OF BATHERSBY HALL;

CONSTRUCT NEW ENTRY STATEMENT INTO SENIOR SCHOOL VIA CORUNDUM STREET;

SAFETY UPGRADES TO EXISTING ITD SPACES

DOOR INSTALLATION AND RESOURCE CENTRE INSTALLATION TO LANGUAGE LAB

ACQUIRE LOT 1 (RP88794);

ACQUIRE LOT 2 (RP907833);

REFURBISH EXISTING SHED INTO AGRICULTURAL SHED TO LOT 2 (RP907833) + UPGRADE LOT 1 / RP88794 FOR AGRICULTURAL STUDIES

CONSTRUCT NEW LINE-MARKING TO EXISTING HARDSTAND TO LOT 2 (RP907833) TO CREATE NEW STAFF PARKING;

STAGE 2:

PRIMARY SCHOOL:

REFURBISH EXISTING PRIMARY GLA BUILDINGS AND AMENITIES;

CONSTRUCT NEW COVERED ROOF OVER EXISTING BASKETBALL HALF-COURT;

CONSTRUCT ADDITIONAL AWNING OVER LIBRARY / ADMIN BUILDING ENTRY;

NEW MURAL ARTWORK TO END OF GLA BUILDING

RECONFIGURE OLD MUSIC AND COUNSELLOR ROOMS FOR NEW TEACHING SPACES

RECONFIGURE TUCKSHOP JOINERY FOR FRIDGE AND HANDWASH BASIN

SENIOR SCHOOL:

REFURBISH PORTION OF PARISH CENTRE INTO NEW HISTORY ROOM;

DEMOLISH PORTION OF EXISTING ITD TO ALLOW FOR NEW WORKS;

CONSTRUCT NEW TWO-STOREY GLA AND ITD EXTENSION TO LINK INTO EXISTING HOME EC. BUILDING;

NEW THROW ZONE, PATHING AND LANDSCAPING

REFURBISH EXISTING AMENITIES

STAGE 3:

PRIMARY SCHOOL:

ACQUIRE LOT 2 (RP62401);

DEMOLISH STRUCTURES AND LANDSCAPING TO LOT 2 (RP62401);

CONSTRUCT NEW TERRACED SEATING TO NEW SPORTING FIELD;

CONSTRUCT NEW JUMPS PIT AND SHOT-PUT ARENA;

CONSTRUCT NEW FULL-SIZE NETBALL COURT;

CONSTRUCT NEW PATHING TO LINK THE TERRACE WITH THE EXISTING SCHOOL PATHING NETWORK;

DEMOLISH EXISTING LANDSCAPING ADJOINING PREP PLAY SPACE;

CONSTRUCT NEW 'NINJA WARRIOR' INSPIRED PLAY SPACE;

CONSTRUCT NEW RETAINING WALL TO TIERED OVALS;

SENIOR SCHOOL:

DEMOLISH EXISTING DILAPIDATED HARDSTAND TO CENTRAL PLAZA SPACE;

REFURBISH EXISTING HOME EC BUILDING;

CONSTRUCT NEW TUCKSHOP TO SOUTH-EASTERN SIDE OF HOME EC. BUILDING;

CONSTRUCT NEW ROOFED STRUCTURE BETWEEN STAFF ROOM AND HOME ECONOMICS BUILDING.

STAGE 4:

PRIMARY SCHOOL:

ADMINISTRATION EXPANSION AND SHOWER & HANDBASIN TO BE RETROFITTED

SENIOR SCHOOL:

CONSTRUCT NEW ROOF STRUCTURE AND PATHING ADJOINING SCIENCE LABS;

ACQUIRE LOT 1 (RP85753);

DEMOLISH STRUCTURES AND LANDSCAPING TO NEWLY ACQUIRED LOTS;

ACQUIRE LOTS 311 + 312 (RP1682);

DEMOLISH STRUCTURES AND LANDSCAPING TO NEWLY ACQUIRED LOTS;

CONSTRUCT NEW CRICKET NETS;

STAGE 5:

PRIMARY SCHOOL:

CONSTRUCT NEW TRAFFIC ISLANDS AND DROP OFF ZONES

SENIOR SCHOOL:

CONSTRUCT NEW TRAFFIC ISLANDS AND DROP OFF ZONES

CONSTRUCT NEW TIERED SPORTS SEATING;

CONSTRUCT NEW 'LONG JUMP' PIT;

UPGRADE SPORTING FIELD

NEW MURAL ARTWORK TO SHOPPING CENTRE WALL

2 Stage 2 Demolition
1: 1000

1 Stage 2 Proposed
1: 1000



ASPECT

ARCHITECTURE
INTERIORS
PROJECT MANAGEMENT
QUANTITY SURVEYING

St. Joseph's School, Stanthorpe

Stage 2 Master Plan

A.011

Project No.

18-0802

TOOWOOMBA | BRISBANE
P. (07) 46 329 962 | WWW.ASPECTAPM.NET
A.B.N 96071786948 | BOAQ 4487

CONCEPT DESIGN ISSUE

Revision

C | 06/11/18

Designer

KGM

Scale

As indicated @ A1

1 2 3 4

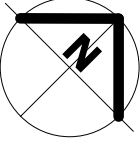

EXISTING STRUCTURES

DEMOLISHED STRUCTURES

PROPOSED BUILDING/ROOF STRUCTURE

RE-FURBISHED STRUCTURES

NEW PATHWAYS

EXISTING CONCRETE PATHWAY

BITUMEN ROAD

PROPOSED GARDEN

TURFED AREAS - EXISTING + PROPOSED

EXISTING TREE

NEW TREE

DEMOLISHED TREE

NEW SHRUBS/PLANTS

STAGING LEGEND

STAGE 1:

PRIMARY SCHOOL:

ACQUIRE LOT 1 (RP52967) - EXISTING ARCHBISHOPS HOUSE; REFURBISH EXISTING ARCHBISHOPS HOUSE TO PROVIDE NEW MUSIC, DIGITAL TECH, STEM, TEXTBOOK STORAGE AND BOOK HIRE;

DEMOLISH EXISTING GRAVEL ROAD;

DEMOLISH EXISTING CRICKET NETS;

CONSTRUCT NEW CRICKET NETS;

CONSTRUCT NEW PATHING AND LANDSCAPING TO LINK INTO REFURBISHED HERITAGE BUILDING - NEW PATHING TO CONNECT INTO EXISTING AMENITIES.

SENIOR SCHOOL:

CONSTRUCT NEW ROOF STRUCTURE AND PATHING TO FRAYNE BUILDING;

DEMOLISH EXISTING DILAPIDATED AMENITIES ADJOINING BATHERSBY HALL;

REFURBISH EXISTING AND PROVIDE NEW AMENITIES TO BATHERSBY HALL;

CONSTRUCT NEW PATHING AND LANDSCAPING INTO EXISTING ENTRY POINTS TO BATHERSBY HALL;

CONSTRUCT NEW ENTRY STRUCTURE TO THE SOUTHERN ENTRY OF BATHERSBY HALL;

CONSTRUCT NEW ENTRY STATEMENT INTO SENIOR SCHOOL VIA CORUNDUM STREET;

SAFETY UPGRADES TO EXISTING ITD SPACES

DOOR INSTALLATION AND RESOURCE CENTRE INSTALLATION TO LANGUAGE LAB

ACQUIRE LOT 1 (RP88794);

ACQUIRE LOT 2 (RP907833);

REFURBISH EXISTING SHED INTO AGRICULTURAL SHED TO LOT 2 (RP907833) + UPGRADE LOT 1 / RP88794 FOR AGRICULTURAL STUDIES

CONSTRUCT NEW LINE-MARKING TO EXISTING HARDSTAND TO LOT 2 (RP907833) TO CREATE NEW STAFF PARKING;

STAGE 2:

PRIMARY SCHOOL:

REFURBISH EXISTING PRIMARY GLA BUILDINGS AND AMENITIES;

CONSTRUCT NEW COVERED ROOF OVER EXISTING BASKETBALL HALF-COURT;

CONSTRUCT ADDITIONAL AWNING OVER LIBRARY / ADMIN BUILDING ENTRY;

NEW MURAL ARTWORK TO END OF GLA BUILDING

RECONFIGURE OLD MUSIC AND COUNSELLOR ROOMS FOR NEW TEACHING SPACES

RECONFIGURE TUCKSHOP JOINERY FOR FRIDGE AND HANDWASH BASIN

SENIOR SCHOOL:

REFURBISH PORTION OF PARISH CENTRE INTO NEW HISTORY ROOM;

DEMOLISH PORTION OF EXISTING ITD TO ALLOW FOR NEW WORKS;

CONSTRUCT NEW TWO-STOREY GLA AND ITD EXTENSION TO LINK INTO EXISTING HOME EC BUILDING;

NEW THROW ZONE, PATHING AND LANDSCAPING

REFURBISH EXISTING AMENITIES

STAGE 3:

PRIMARY SCHOOL:

ACQUIRE LOT 2 (RP62401);

DEMOLISH STRUCTURES AND LANDSCAPING TO LOT 2 (RP62401);

CONSTRUCT NEW TERRACED SEATING TO NEW SPORTING FIELD;

CONSTRUCT NEW JUMPS PIT AND SHOT-PUT ARENA;

CONSTRUCT NEW FULL-SIZE NETBALL COURT;

CONSTRUCT NEW PATHING TO LINK THE TERRACE WITH THE EXISTING SCHOOL PATHING NETWORK;

DEMOLISH EXISTING LANDSCAPING ADJOINING PREP PLAY SPACE;

CONSTRUCT NEW 'NINJA WARRIOR' INSPIRED PLAY SPACE;

CONSTRUCT NEW RETAINING WALL TO TIERED OVALS;

SENIOR SCHOOL:

DEMOLISH EXISTING DILAPIDATED HARDSTAND TO CENTRAL PLAZA SPACE;

REFURBISH EXISTING HOME EC BUILDING;

CONSTRUCT NEW TUCKSHOP TO SOUTH-EASTERN SIDE OF HOME EC BUILDING;

CONSTRUCT NEW ROOFED STRUCTURE BETWEEN STAFF ROOM AND HOME ECONOMICS BUILDING.

STAGE 4:

PRIMARY SCHOOL:

ADMINISTRATION EXPANSION AND SHOWER & HANDBASIN TO BE RETROFITTED

SENIOR SCHOOL:

CONSTRUCT NEW ROOF STRUCTURE AND PATHING ADJOINING SCIENCE LABS;

ACQUIRE LOT 1 (RP85753);

DEMOLISH STRUCTURES AND LANDSCAPING TO NEWLY ACQUIRED LOTS;

ACQUIRE LOTS 311 + 312 (RP1682);

DEMOLISH STRUCTURES AND LANDSCAPING TO NEWLY ACQUIRED LOTS;

CONSTRUCT NEW CRICKET NETS;

STAGE 5:

PRIMARY SCHOOL:

CONSTRUCT NEW TRAFFIC ISLANDS AND DROP OFF ZONES

SENIOR SCHOOL:

CONSTRUCT NEW TRAFFIC ISLANDS AND DROP OFF ZONES

CONSTRUCT NEW TIERED SPORTS SEATING;

CONSTRUCT NEW LONG JUMP PIT;

UPGRADE SPORTING FIELD

NEW MURAL ARTWORK TO SHOPPING CENTRE WALL

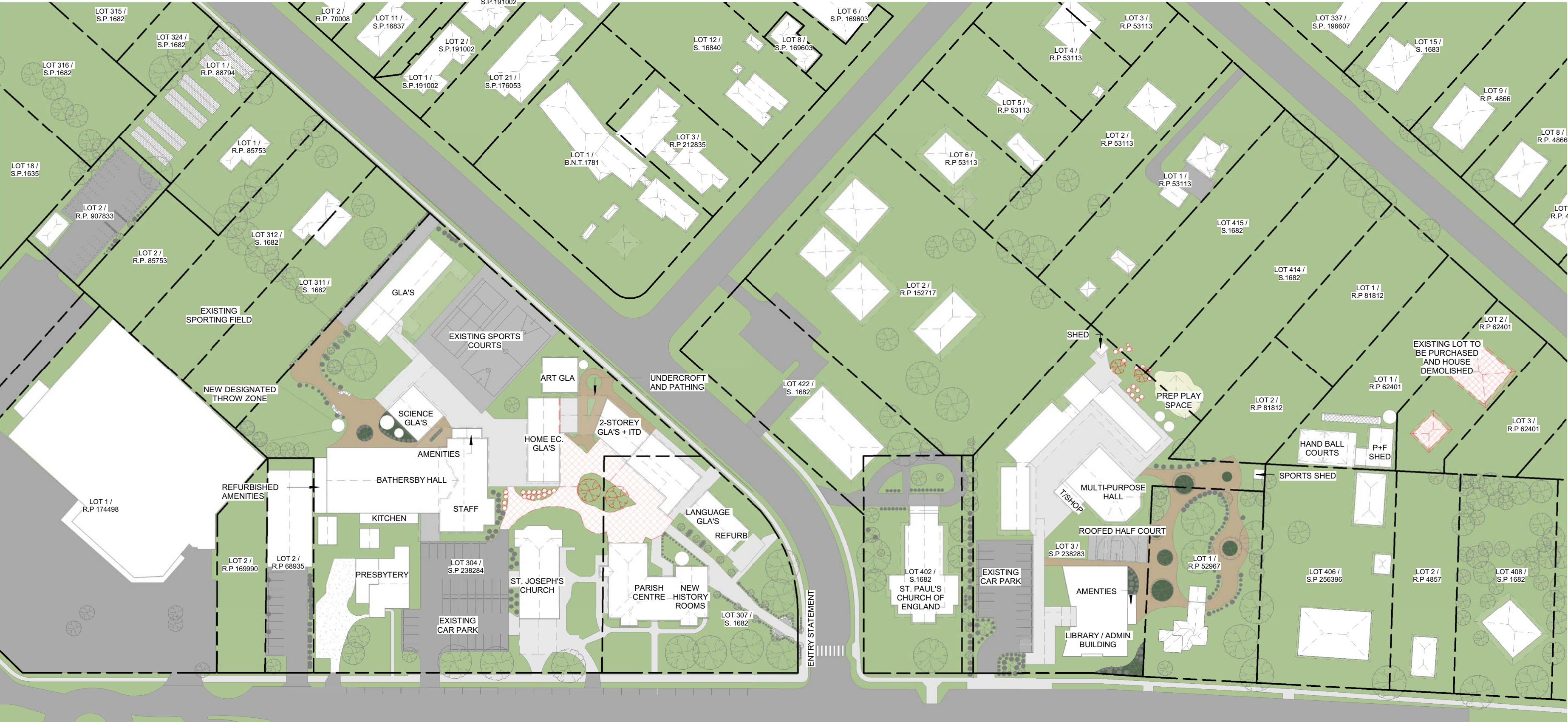

1 Stage 3 Demolition
1 : 1000

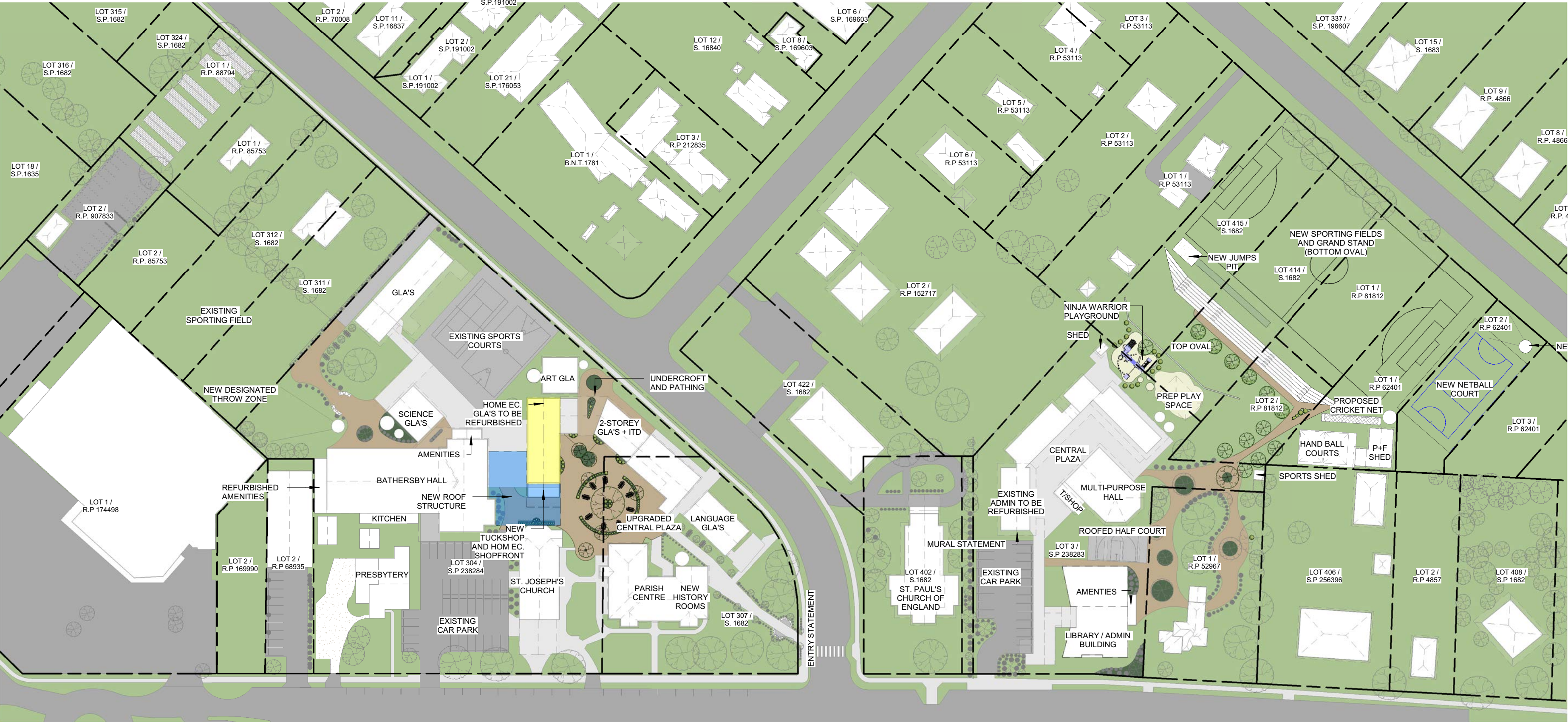

2 Stage 3 Proposed
1 : 1000

EXISTING STRUCTURES

DEMOLISHED STRUCTURES

PROPOSED BUILDING/ROOF STRUCTURE

RE-FURNISHED STRUCTURES

NEW PATHWAYS

EXISTING CONCRETE PATHWAY

BITUMEN ROAD

PROPOSED GARDEN

TURFED AREAS - EXISTING + PROPOSED

EXISTING TREE

NEW TREE

DEMOLISHED TREE

NEW SHRUBS/PLANTS

STAGING LEGEND

STAGE 1:

PRIMARY SCHOOL:

ACQUIRE LOT 1 (RP52967) - EXISTING ARCHBISHOPS HOUSE;

REFURBISH EXISTING ARCHBISHOPS HOUSE TO PROVIDE NEW MUSIC, DIGITAL TECH, STEM, TEXTBOOK STORAGE AND BOOK HIRE;

DEMOLISH EXISTING GRAVEL ROAD;

DEMOLISH EXISTING CRICKET NETS;

CONSTRUCT NEW CRICKET NETS;

CONSTRUCT NEW PATHING AND LANDSCAPING TO LINK INTO REFURBISHED HERITAGE BUILDING - NEW PATHING TO CONNECT INTO EXISTING AMENITIES.

SENIOR SCHOOL:

CONSTRUCT NEW ROOF STRUCTURE AND PATHING TO FRAYNE BUILDING;

DEMOLISH EXISTING DILAPIDATED AMENITIES ADJOINING BATHERSBY HALL;

REFURBISH EXISTING AND PROVIDE NEW AMENITIES TO BATHERSBY HALL;

CONSTRUCT NEW PATHING AND LANDSCAPING INTO EXISTING ENTRY POINTS TO BATHERSBY HALL;

CONSTRUCT NEW ENTRY STRUCTURE TO THE SOUTHERN ENTRY OF BATHERSBY HALL;

CONSTRUCT NEW ENTRY STATEMENT INTO SENIOR SCHOOL VIA CORUNDUM STREET;

SAFETY UPGRADES TO EXISTING ITD SPACES

DOOR INSTALLATION AND RESOURCE CENTRE INSTALLATION TO LANGUAGE LAB

ACQUIRE LOT 1 (RP8794);

ACQUIRE LOT 2 (RP907833);

REFURBISH EXISTING SHED INTO AGRICULTURAL SHED TO LOT 2 (RP907833) + UPGRADE LOT 1 / RP8794 FOR AGRICULTURAL STUDIES

CONSTRUCT NEW LINE-MARKING TO EXISTING HARDSTAND TO LOT 2 (RP907833) TO CREATE NEW STAFF PARKING;

STAGE 2:

PRIMARY SCHOOL:

REFURBISH EXISTING PRIMARY GLA BUILDINGS AND AMENITIES;

CONSTRUCT NEW COVERED ROOF OVER EXISTING BASKETBALL HALF-COURT;

CONSTRUCT ADDITIONAL AWNING OVER LIBRARY / ADMIN BUILDING ENTRY;

NEW MURAL ARTWORK TO END OF GLA BUILDING

RECONFIGURE OLD MUSIC AND COUNSELLOR ROOMS FOR NEW TEACHING SPACES

RECONFIGURE TUCKSHOP JOINERY FOR FRIDGE AND HANDWASH BASIN

SENIOR SCHOOL:

REFURBISH PORTION OF PARISH CENTRE INTO NEW HISTORY ROOM;

DEMOLISH PORTION OF EXISTING ITD TO ALLOW FOR NEW WORKS;

CONSTRUCT NEW TWO-STOREY GLA AND ITD EXTENSION TO LINK INTO EXISTING HOME EC BUILDING;

NEW THROW ZONE, PATHING AND LANDSCAPING

REFURBISH EXISTING AMENITIES

STAGE 3:

PRIMARY SCHOOL:

ACQUIRE LOT 2 (RP62401);

DEMOLISH STRUCTURES AND LANDSCAPING TO LOT 2 (RP62401);

CONSTRUCT NEW TERRACED SEATING TO NEW SPORTING FIELD;

CONSTRUCT NEW JUMPS PIT AND SHOT-PUT ARENA;

CONSTRUCT NEW FULL-SIZE NETBALL COURT;

CONSTRUCT NEW PATHING TO LINK THE TERRACE WITH THE EXISTING SCHOOL PATHING NETWORK;

DEMOLISH EXISTING LANDSCAPING ADJOINING PREP PLAY SPACE;

CONSTRUCT NEW 'NINJA WARRIOR' INSPIRED PLAY SPACE;

CONSTRUCT NEW RETAINING WALL TO TIERED OVALS;

SENIOR SCHOOL:

DEMOLISH EXISTING DILAPIDATED HARDSTAND TO CENTRAL PLAZA SPACE;

REFURBISH EXISTING HOME EC BUILDING;

CONSTRUCT NEW TUCKSHOP TO SOUTH-EASTERN SIDE OF HOME EC BUILDING;

CONSTRUCT NEW ROOFED STRUCTURE BETWEEN STAFF ROOM AND HOME ECONOMICS BUILDING.

STAGE 4:

PRIMARY SCHOOL:

ADMINISTRATION EXPANSION AND SHOWER & HANDBASIN TO BE RETROFITTED

SENIOR SCHOOL:

CONSTRUCT NEW ROOF STRUCTURE AND PATHING ADJOINING SCIENCE LABS;

ACQUIRE LOT 1 (RP85753);

DEMOLISH STRUCTURES AND LANDSCAPING TO NEWLY ACQUIRED LOTS;

ACQUIRE LOTS 311 + 312 (RP1682);

DEMOLISH STRUCTURES AND LANDSCAPING TO NEWLY ACQUIRED LOTS;

CONSTRUCT NEW CRICKET NETS;

STAGE 5:

PRIMARY SCHOOL:

CONSTRUCT NEW TRAFFIC ISLANDS AND DROP OFF ZONES

SENIOR SCHOOL:

CONSTRUCT NEW TRAFFIC ISLANDS AND DROP OFF ZONES

CONSTRUCT NEW TIERED SPORTS SEATING;

CONSTRUCT NEW LONG JUMP PIT;

UPGRADE SPORTING FIELD

1 Stage 4 Demolition
1 : 1000

2 Stage 4 Proposed
1 : 1000

ASPECT

ARCHITECTURE
INTERIORS
PROJECT MANAGEMENT
QUANTITY SURVEYING

TOOWOOMBA | BRISBANE
P. (07) 46 329 962 | WWW.ASPECTAPM.NET
A.B.N 96071786948 | BOAQ 4487

St. Joseph's School, Stanthorpe

Stage 4 Master Plan

A.013

Project No. 18-0802

CONCEPT DESIGN ISSUE

Revision

C | 06/11/18

Designer

KGM

Scale

As indicated @ A1

1 2 3 4

EXISTING STRUCTURES

DEMOLISHED STRUCTURES

PROPOSED BUILDING/ROOF STRUCTURE

RE-FURBISHED STRUCTURES

NEW PATHWAYS

EXISTING CONCRETE PATHWAY

BITUMEN ROAD

PROPOSED GARDEN

TURFED AREAS - EXISTING + PROPOSED

EXISTING TREE

NEW TREE

DEMOLISHED TREE

NEW SHRUBS/PLANTS

STAGING LEGEND

STAGE 1:

PRIMARY SCHOOL:

ACQUIRE LOT 1 (RP62967) - EXISTING ARCHBISHOPS HOUSE;

REFURBISH EXISTING ARCHBISHOPS HOUSE TO PROVIDE NEW MUSIC, DIGITAL TECH, STEM, TEXTBOOK STORAGE AND BOOK HIRE;

DEMOLISH EXISTING GRAVEL ROAD;

DEMOLISH EXISTING CRICKET NETS;

CONSTRUCT NEW CRICKET NETS;

CONSTRUCT NEW PATHING AND LANDSCAPING TO LINK INTO REFURBISHED HERITAGE BUILDING - NEW PATHING TO CONNECT INTO EXISTING AMENITIES.

SENIOR SCHOOL:

CONSTRUCT NEW ROOF STRUCTURE AND PATHING TO FRAYNE BUILDING;

DEMOLISH EXISTING DILAPIDATED AMENITIES ADJOINING BATHERSBY HALL;

REFURBISH EXISTING AND PROVIDE NEW AMENITIES TO BATHERSBY HALL;

CONSTRUCT NEW PATHING AND LANDSCAPING INTO EXISTING ENTRY POINTS TO BATHERSBY HALL;

CONSTRUCT NEW ENTRY STRUCTURE TO THE SOUTHERN ENTRY OF BATHERSBY HALL;

CONSTRUCT NEW ENTRY STATEMENT INTO SENIOR SCHOOL VIA CORUNDUM STREET;

SAFETY UPGRADES TO EXISTING ITD SPACES

DOOR INSTALLATION AND RESOURCE CENTRE INSTALLATION TO LANGUAGE LAB

ACQUIRE LOT 1 (RP88794);

ACQUIRE LOT 2 (RP907833);

REFURBISH EXISTING SHED INTO AGRICULTURAL SHED TO LOT 2 (RP907833) + UPGRADE LOT 1 / RP88794 FOR AGRICULTURAL STUDIES

CONSTRUCT NEW LINE-MARKING TO EXISTING HARDSTAND TO LOT 2 (RP907833) TO CREATE NEW STAFF PARKING;

STAGE 2:

PRIMARY SCHOOL:

REFURBISH EXISTING PRIMARY GLA BUILDINGS AND AMENITIES;

CONSTRUCT NEW COVERED ROOF OVER EXISTING BASKETBALL HALF COURT;

CONSTRUCT ADDITIONAL AWNING OVER LIBRARY / ADMIN BUILDING ENTRY;

NEW MURAL ARTWORK TO END OF GLA BUILDING

RECONFIGURE OLD MUSIC AND COUNSELLOR ROOMS FOR NEW TEACHING SPACES

RECONFIGURE TUCKSHOP JOINERY FOR FRIDGE AND HANDWASH BASIN

SENIOR SCHOOL:

REFURBISH PORTION OF PARISH CENTRE INTO NEW HISTORY ROOM;

DEMOLISH PORTION OF EXISTING ITD TO ALLOW FOR NEW WORKS;

CONSTRUCT NEW TWO-STOREY GLA AND ITD EXTENSION TO LINK INTO EXISTING HOME EC. BUILDING;

NEW THROW ZONE, PATHING AND LANDSCAPING

REFURBISH EXISTING AMENITIES

STAGE 3:

PRIMARY SCHOOL:

ACQUIRE LOT 2 (RP62401);

DEMOLISH STRUCTURES AND LANDSCAPING TO LOT 2 (RP62401);

CONSTRUCT NEW TERRACED SEATING TO NEW SPORTING FIELD;

CONSTRUCT NEW JUMPS PIT AND SHOT-PUT ARENA;

CONSTRUCT NEW FULL-SIZE NETBALL COURT;

CONSTRUCT NEW PATHING TO LINK THE TERRACE WITH THE EXISTING SCHOOL PATHING NETWORK;

DEMOLISH EXISTING LANDSCAPING ADJOINING PREP PLAY SPACE;

CONSTRUCT NEW 'NINJA WARRIOR' INSPIRED PLAY SPACE;

CONSTRUCT NEW RETAINING WALL TO TIERED OVALS;

SENIOR SCHOOL:

DEMOLISH EXISTING DILAPIDATED HARDSTAND TO CENTRAL PLAZA SPACE;

REFURBISH EXISTING HOME EC BUILDING;

CONSTRUCT NEW TUCKSHOP TO SOUTH-EASTERN SIDE OF HOME EC. BUILDING;

CONSTRUCT NEW ROOFED STRUCTURE BETWEEN STAFF ROOM AND HOME ECONOMICS BUILDING.

STAGE 4:

PRIMARY SCHOOL:

ADMINISTRATION EXPANSION AND SHOWER & HANDBASIN TO BE RETROFITTED

SENIOR SCHOOL:

CONSTRUCT NEW ROOF STRUCTURE AND PATHING ADJOINING SCIENCE LABS;

ACQUIRE LOT 1 (RP85753);

DEMOLISH STRUCTURES AND LANDSCAPING TO NEWLY ACQUIRED LOTS;

ACQUIRE LOTS 311 + 312 (RP1682);

DEMOLISH STRUCTURES AND LANDSCAPING TO NEWLY ACQUIRED LOTS;

CONSTRUCT NEW CRICKET NETS;

STAGE 5:

PRIMARY SCHOOL:

CONSTRUCT NEW TRAFFIC ISLANDS AND DROP OFF ZONES

SENIOR SCHOOL:

CONSTRUCT NEW TRAFFIC ISLANDS AND DROP OFF ZONES

CONSTRUCT NEW TIERED SPORTS SEATING;

CONSTRUCT NEW LONG JUMP PIT;

UPGRADE SPORTING FIELD

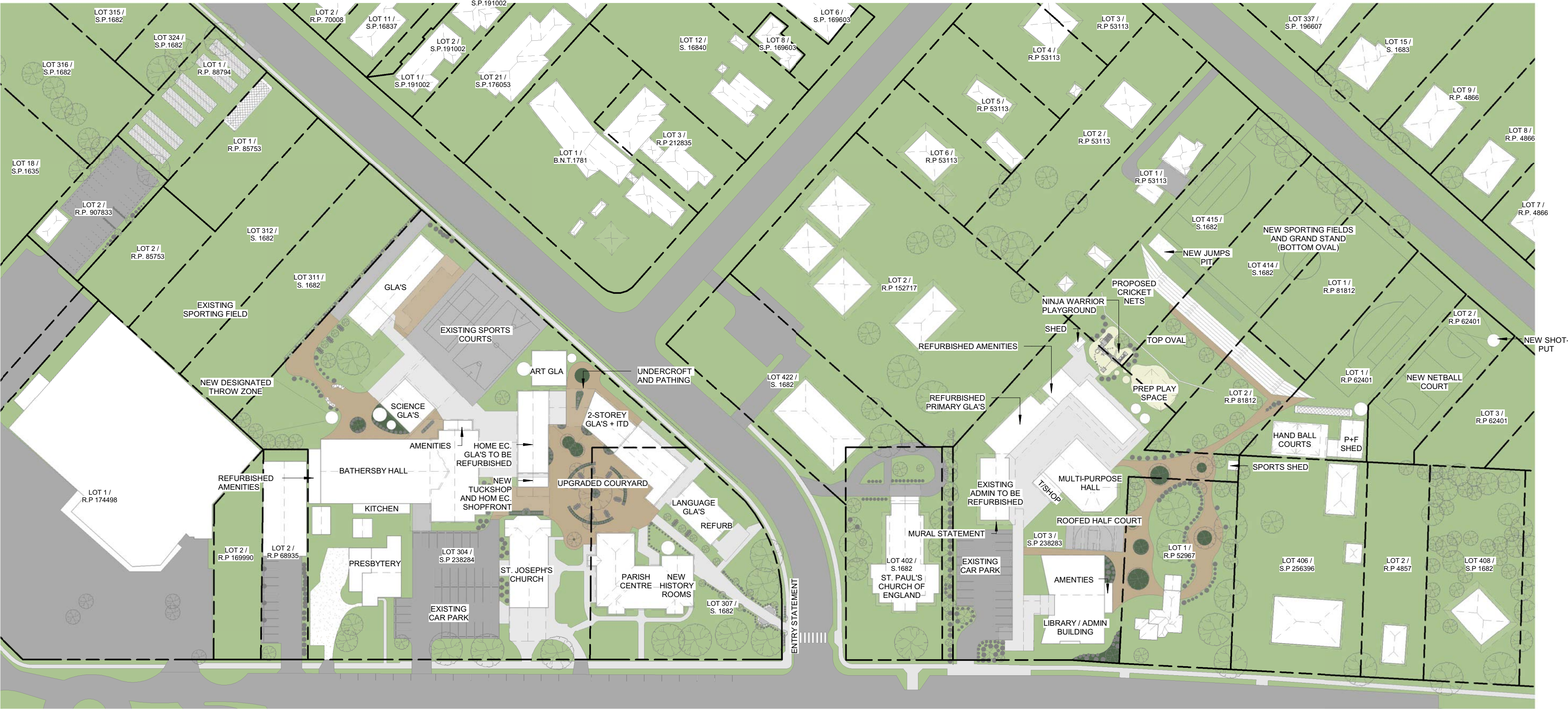

1 Stage 5 Demolition
1 : 1000

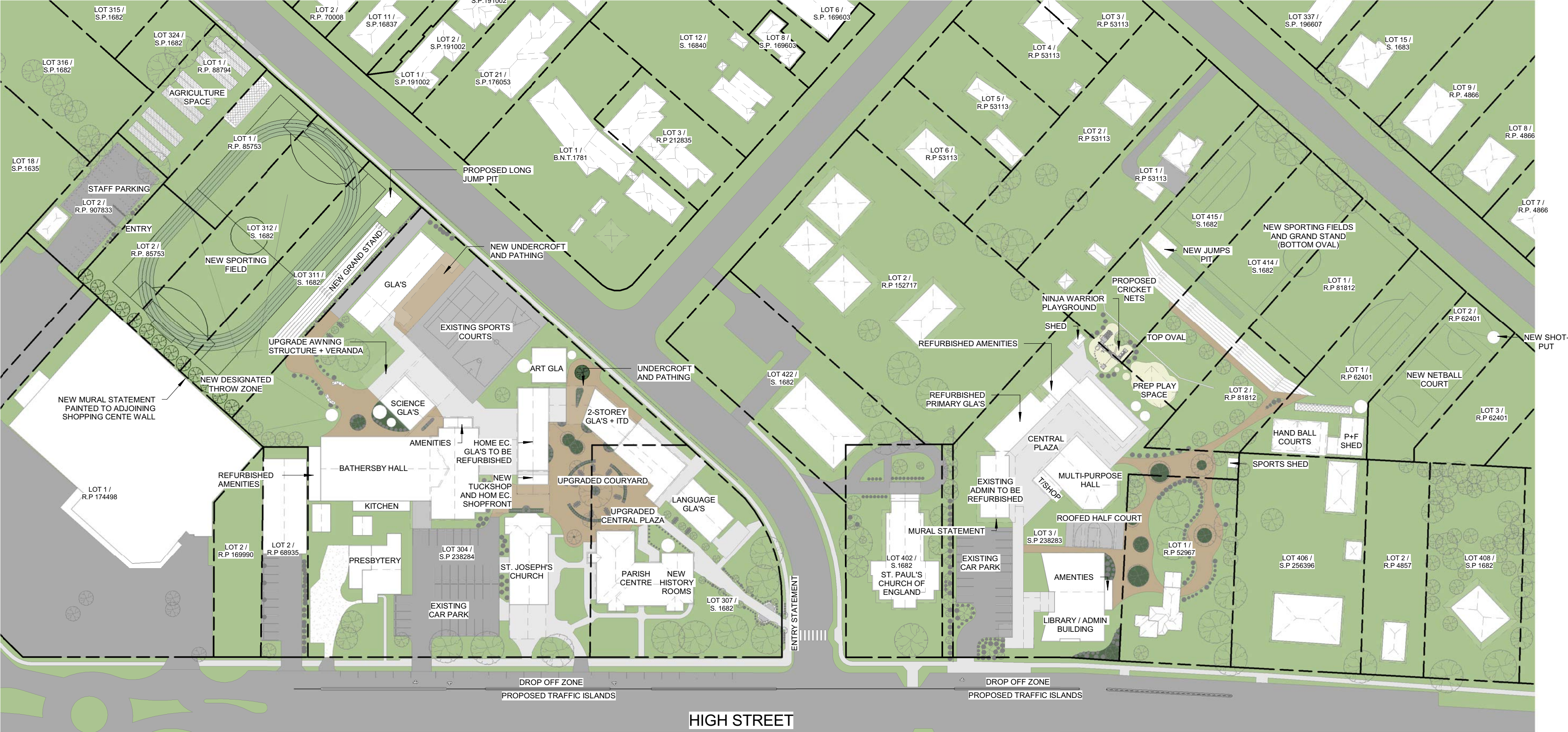

2 Stage 5 Proposed
1 : 1000



① Junior Landscape Plaza



② Senior Plaza



1 Senior Sporting Field



2 Junior Sporting Field